

Agri-Fab®

OWNERS MANUAL

**MODEL NO.
45-01772**

CAUTION:
Read Rules for
Safe Operation
and Instructions
Carefully

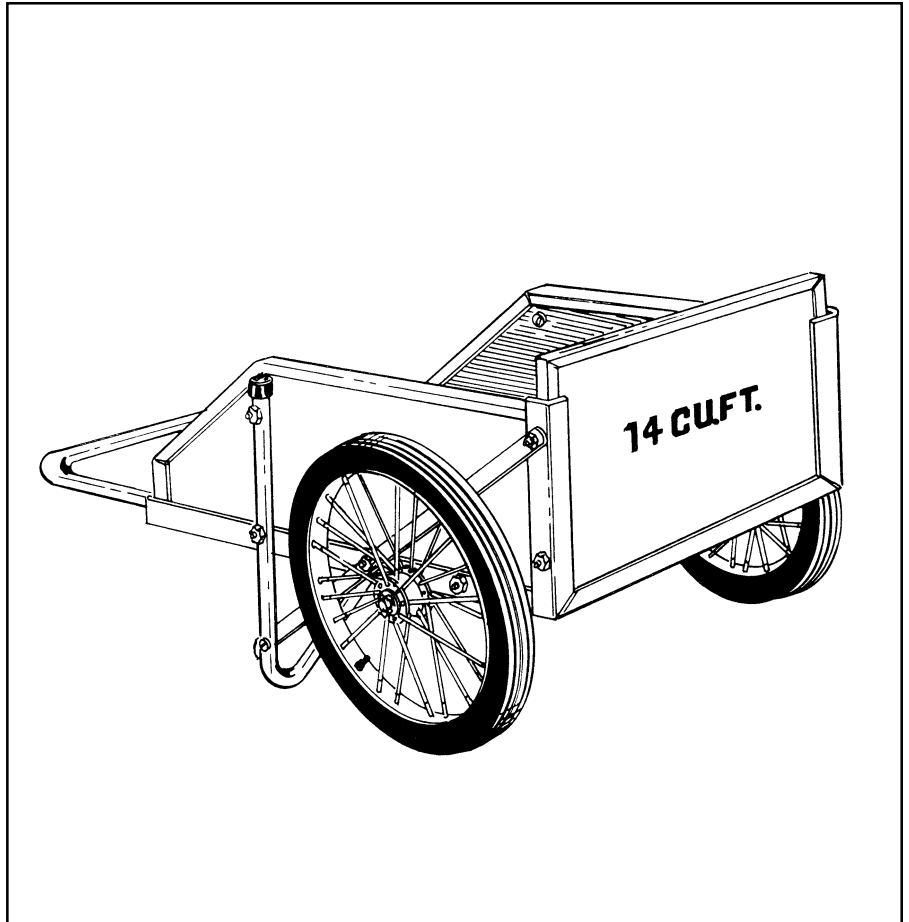

14 CU. FT. FARM/YARD CART

- Safety
- Assembly
- Operation
- Maintenance
- Parts

SpeedPart *the fastest way to purchase parts* www.speedepart.com

RULES FOR SAFE OPERATION

Preventing accidents is the responsibility of every equipment operator. The following general safety precautions must be fully understood and followed by every operator.

1. Do not at any time carry passengers in this cart. It is designed for carrying materials only and not intended to carry passengers.
2. Be careful on any grade (hill) and stay off of steep grades.
3. Use caution when loading cart to avoid tipping.
4. Avoid large holes and ditches when transporting loads.

Your Farm/Yard Cart carton contains a hardware package with parts as shown in the chart below and in figure 1.

Contents of Hardware Pack: (See figure 1)

REF.	QTY.	DESCRIPTION
A	6	Screws, 1/4-20 x 2" Long
B	2	Screws, 1/4-20 x 1-1/2" Long
C	4	Screws, 1/4-20 x 1-1/4" Long
D	25	Screws, 1/4-20 x 1" Long
E	4	Cotter Pins
F	37	Hex Nuts, 1/4-20 Thread
G	4	Flat Washers, 1-1/2" O.D.
H	33	Flat Washer, 1/4" I.D.
I	4	Lock Washers, 1/4"
J	2	Tube Cap, 1" x 1" Long

HARDWARE REFERENCE CHART

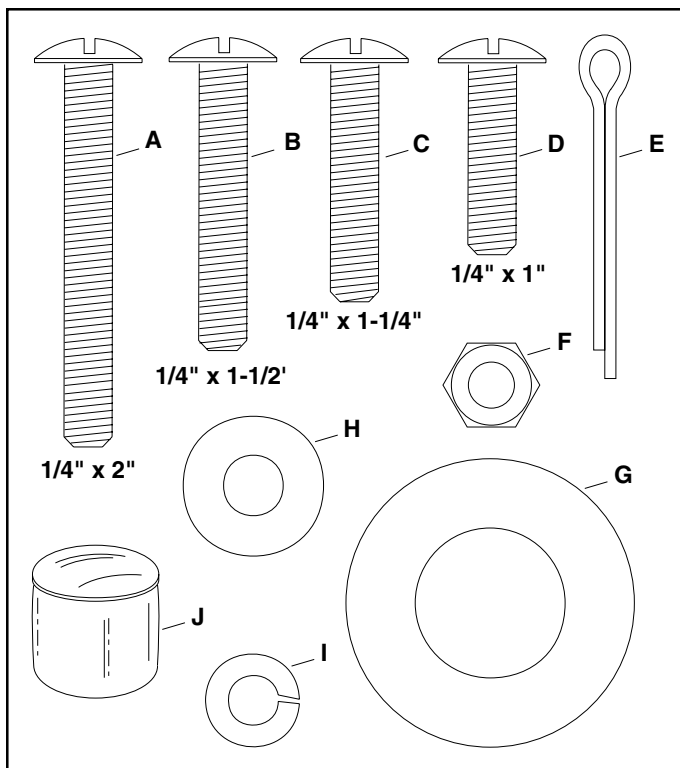

FIGURE 1

ASSEMBLY INSTRUCTIONS

TOOLS REQUIRED

- (1) Screw Driver
- (1) Pliers
- (1) 7/16" Wrench

When assembling your cart, place the heads of all screws to the inside and hex nuts with flat washers to the outside.

1. Lay the front angle assembly down (flat) on floor and stand the bottom panel in position as shown in figure 2.



The bottom panel has one galvanized edge; this is the rear. The front edge has three holes. See figure 2.

2. Line up three holes in bottom panel with holes in front angle assembly. Start three 1/4" x 1" screws through bottom panel, then through angle. Secure screws with flat washers and hex nuts. **Tighten securely.** See figure 2.

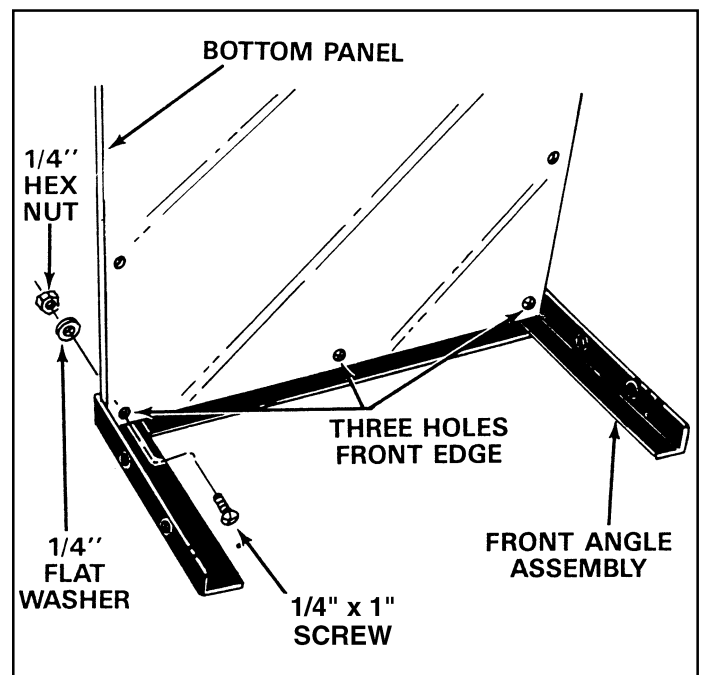

FIGURE 2

3. Turn the front angle assembly and bottom panel upside down as shown in figure 3.
4. Lay each side angle on the bottom panel so that the two holes (for the axle clamp) are closer to the front angle assembly. See figure 3.
5. Secure both axle clamps to the side angles and the bottom panel using four 1/4" x 1-1/4" screws, lock washers and hex nuts. **Make only finger tight** until the axle is assembled. See figure 3.

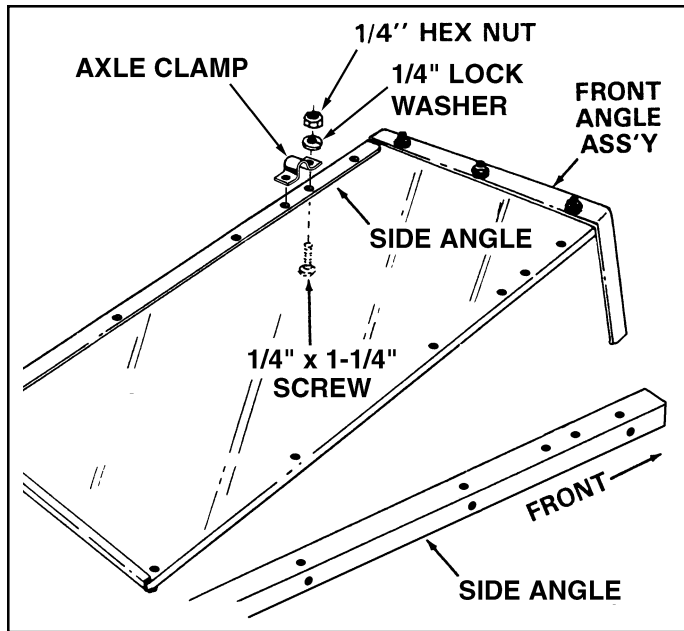

FIGURE 3

6. Assemble four 1/4" x 1" screws, flat washers and hex nuts to the side angles and bottom panel using the holes on each side of the axle clamps. **Tighten the four nuts.** See figure 4.

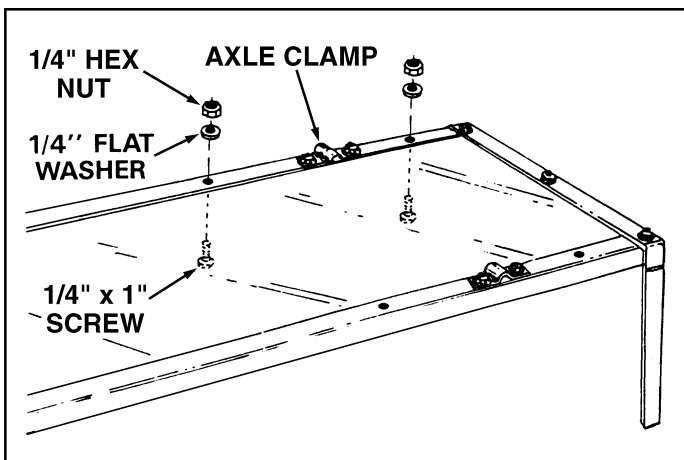

FIGURE 4

7. Stand the cart on end with the front angle assembly down on the floor. Temporarily place the four large 1-1/2" dia. flat washers (axle washers) on the inside of front angle assembly. See figure 5.



These washers act as shims and are just for assembly purposes. You will remove them later to use on the axle.

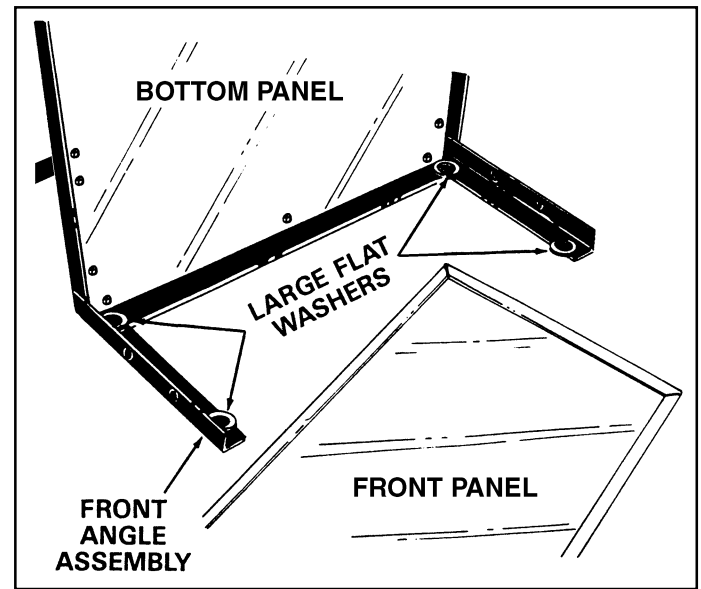

FIGURE 5

8. Lay the front panel down onto the front angle assembly, on top of the four large 1-1/2" dia. washers. See figure 6.

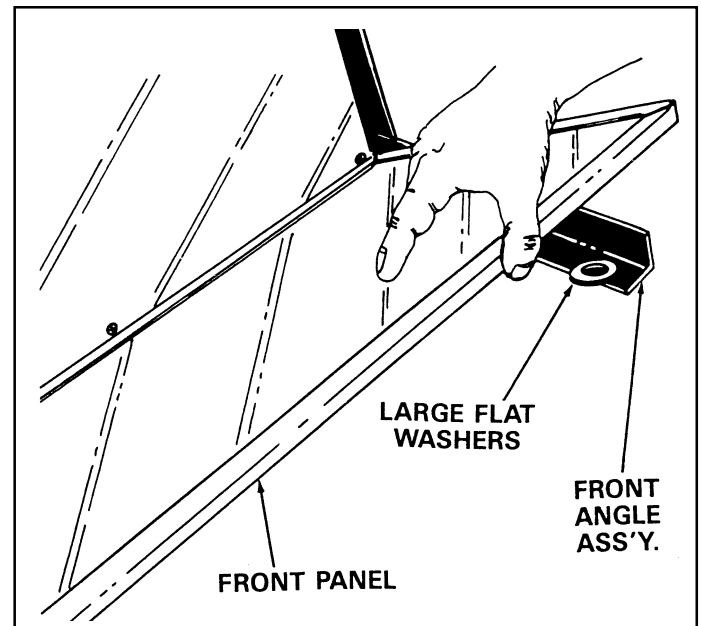

FIGURE 6

9. Position a side panel against a side angle, resting it down on top of the front panel. Place a support strap on the outside of the side angle and start a 1/4" x 1" screw through the **second hole** in the side panel, the side angle and the support strap. Secure with a flat washer and hex nut. **Make only finger tight at this time.** See figure 7.
10. Start a 1/4" x 1" screw through the top hole in the side panel, the front angle assembly and the support strap. Secure with a flat washer and hex nut. **Make only finger tight at this time.** See figure 7.
11. Repeat steps 9 and 10 for the other side panel.

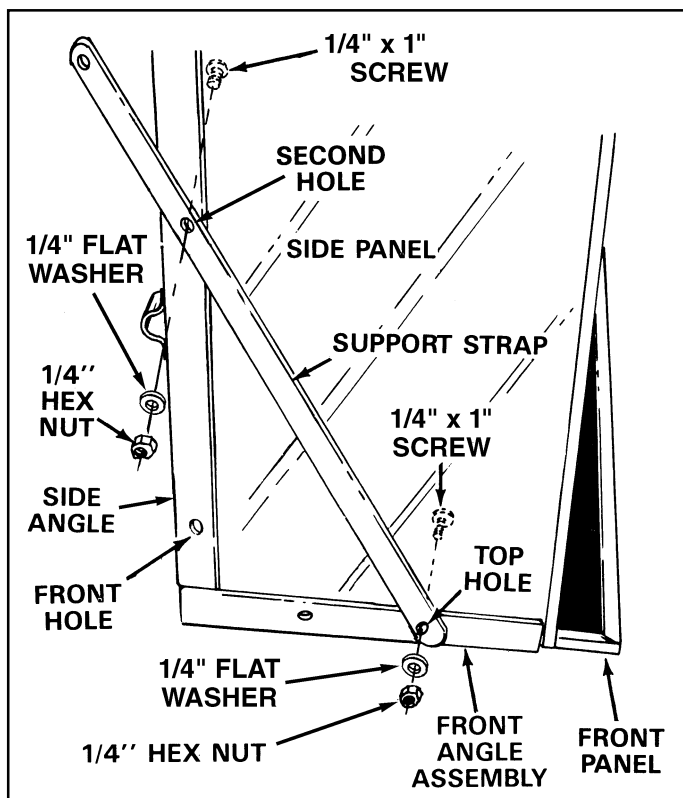

FIGURE 7

12. Start one 1/4" x 1" screw through the bottom hole in the side panel and the front angle assembly. Start another 1/4" x 1" screw through the front hole in the side panel and the side angle. Secure with two flat washers and two hex nuts, **making only finger tight at this time.** See figure 8.
13. Repeat step 12 for the other side panel.
14. **Tighten** all nuts and screws securely at this time, **except** for nuts and screws in axle clamps. See figure 8.

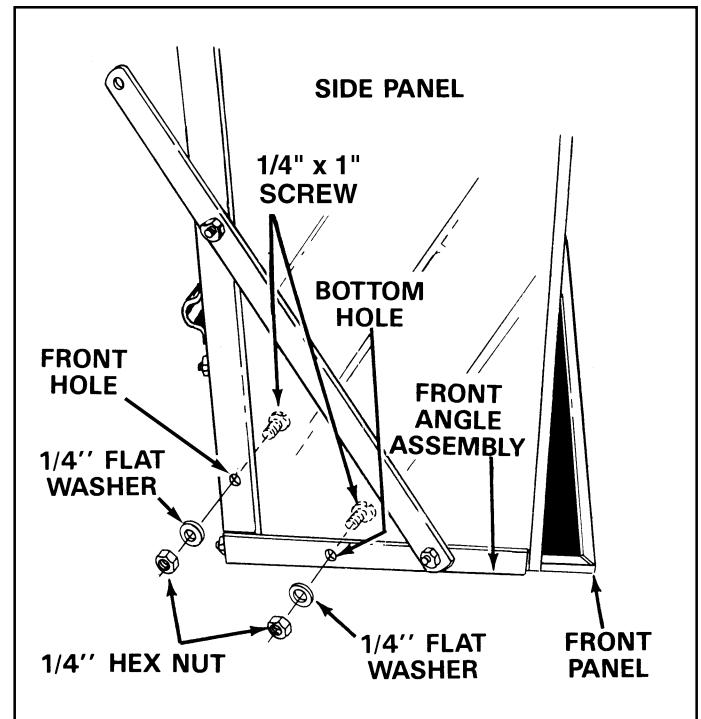

FIGURE 8

15. Lay the cart down on the floor so that the sides are in the normal upright position. Remove the front panel by sliding it up, then remove the four large washers you used for shims. See figure 9.

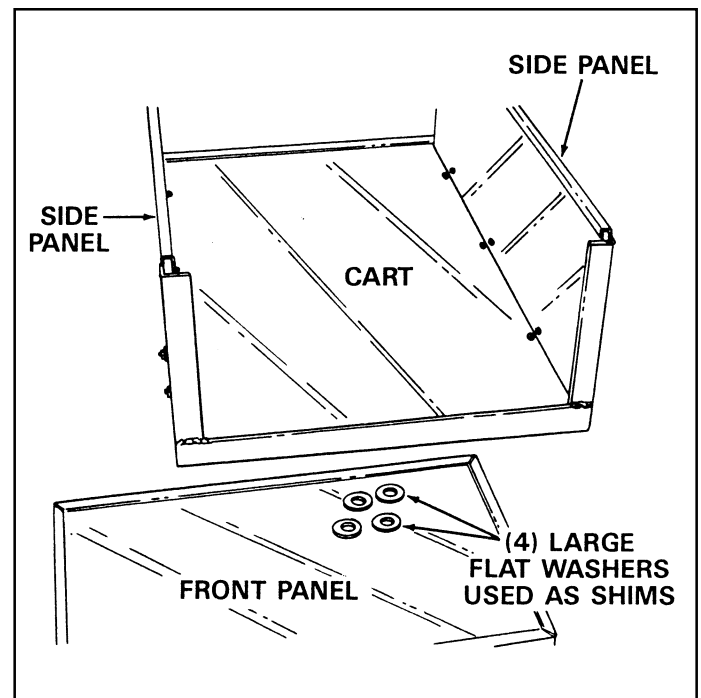

FIGURE 9

16. Turn the cart upside down. Place the handle tube on the bottom of the cart as shown in figure 10. Place the four tube clamps over the handle tube, **with the longer leg of each tube clamp to the outside.** Secure the four tube clamps over the handle tube using eight 1/4" x 1" screws, eight flat washers and eight hex nuts. Make only finger tight until all eight screws are in place and then **tighten securely.** See figure 10.



The length of the handle tube can be adjusted by sliding the tube in or out before tightening the four clamps. See figure 10.

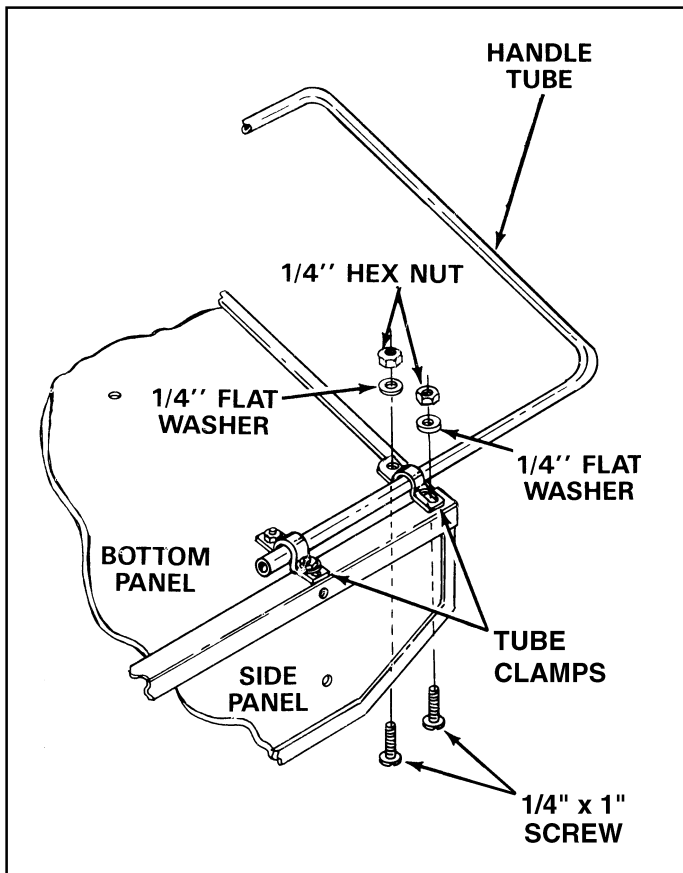

FIGURE 10

17. Insert a 1/4" x 1" screw through the hole at the rear of each side panel and the hole at the rear of each side angle. Secure with 1/4" flat washers and 1/4" hex nuts, **making only finger tight at this time.** See figure 11.

18. Place the tube caps on the ends of the "W" shaped leg tube. See figure 11.

19. With the cart still upside down, assemble the leg tube to the bottom of the cart. Line up the two holes in the center of the leg tube with the holes in the bottom of the cart. Secure the leg tube to the bottom of the cart with two 1/4" x 2" screws, 1/4" flat washers and 1/4" hex nuts. **Make only finger tight at this time.** See figure 11.

20. Attach the leg tube to the side panels with four 1/4" x 2" screws, 1/4" flat washers and 1/4" hex nuts. **Make only finger tight at this time.** See figure 11.

21. Fasten the support straps to the leg tube with two 1/4" x 1-1/2" screws, 1/4" flat washers and 1/4" hex nuts. See figure 11.

22. At this time **tighten securely** all screws and nuts assembled in figure 11.

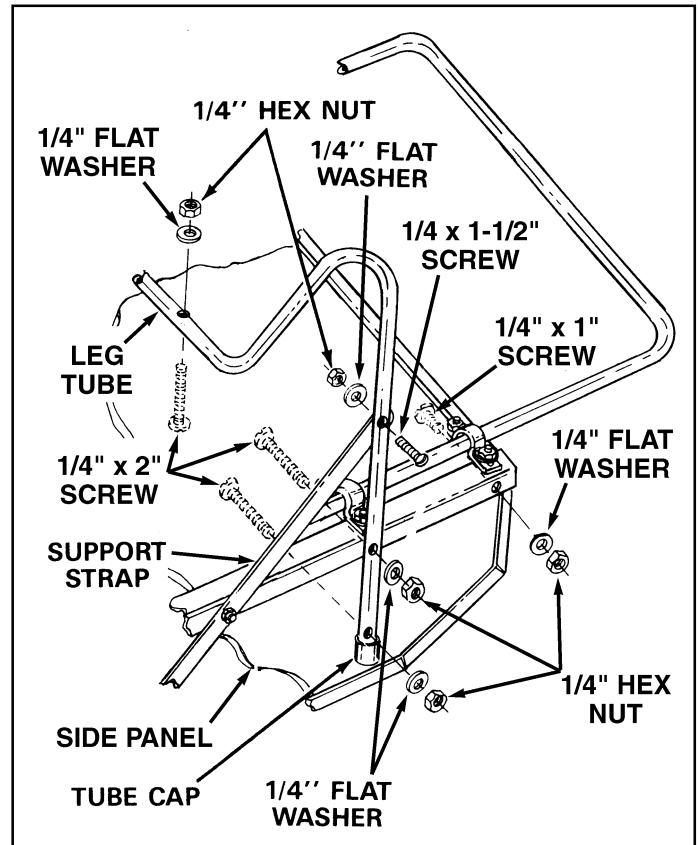

FIGURE 11

23. Slide the axle through the axle clamps. See figure 12.
24. Assemble a cotter pin to the inner hole at one end of the axle. Place a 1-1/2" flat washer, a wheel and then another 1-1/2" flat washer onto the axle. Secure the wheel with a cotter pin assembled to the outer hole at the end of the axle. Repeat step for other wheel. See figure 12.
25. Center the wheels and axle side to side. **Tighten** the four nuts on the axle clamps.

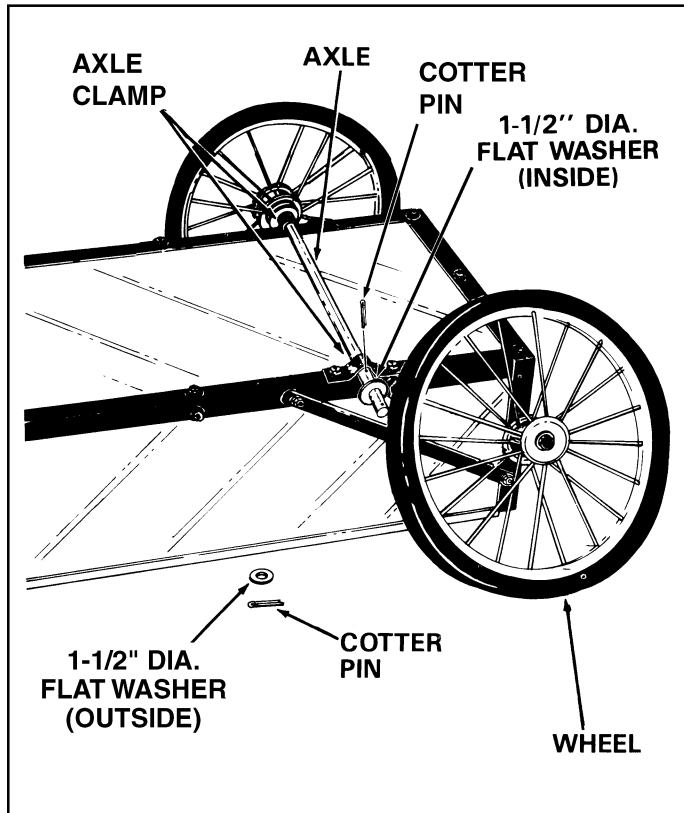

FIGURE 12

26. Turn cart right side up, so that it rests on its wheels.
27. Place front panel in guides to complete assembly.
28. Your cart is now ready to use.

MAINTENANCE

1. Grease or oil wheel bearings occasionally. Use automotive wheel bearing type grease or 20 weight oil.
2. Periodically retighten all screws, especially after heavy use. **Do not exceed load capacity rating of 400 lbs.**
3. Clean cart thoroughly after each use.
4. Store indoors during severe weather.
5. Apply light coat of varnish to all wood surfaces annually.
6. Use glossy black enamel spray paint to touch up scratched or worn painted metal surfaces.

RECOMMENDED TIRE PRESSURE 30-35 PSI

MAXIMUM TIRE PRESSURE 35 PSI

MODEL 45-01772 14 CU. FT. FARM/YARD CART

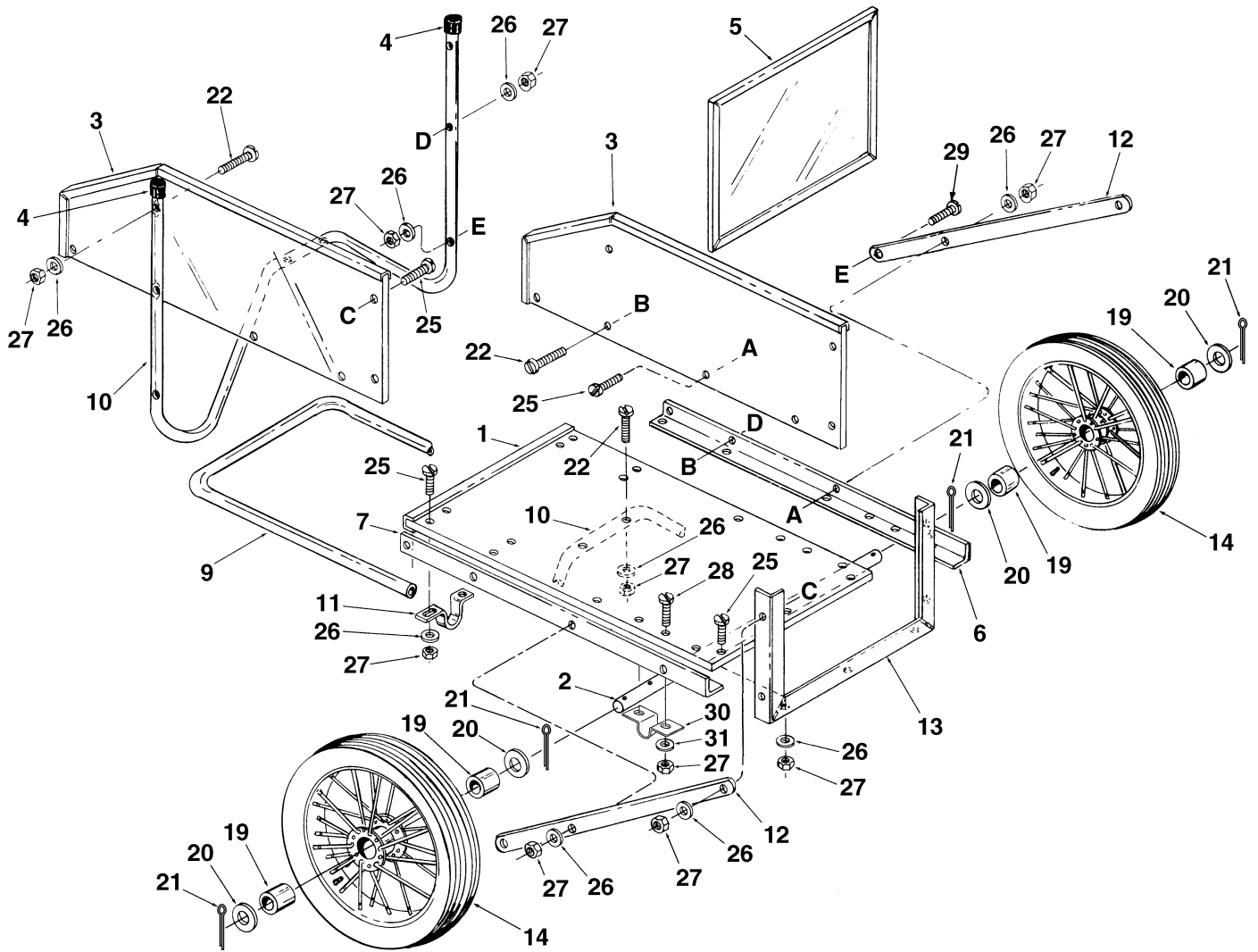

REF. NO.	PART NO.	QTY.	DESCRIPTION	REF. NO.	PART NO.	QTY.	DESCRIPTION
1	47590	1	Bottom Panel	20	43949	4	Flat Washer, 25/32" x 1-1/2" x 3/32"
2	24889	1	Axle, Wheel	21	43010	4	Cotter Pin, 1/8" x 1-1/4" *
3	47589	2	Side Panel	22	47584	6	Truss Head Screw, 1/4-20 x 2" Lg.*
4	44021	2	Tube Caps	25	44259	25	Truss Head Screw, 1/4-20 x 1" Lg.*
5	47588	1	Front Panel	26	43088	33	Flat Washer, 1/4" *
6	24887	1	Side Angle, L.H.	27	43178	37	Hex Nut, 1/4-20 Thread *
7	24888	1	Side Angle, R.H.	28	44020	4	Truss Head Screw, 1/4-20 x 1-1/4" Lg.*
9	44031	1	Handle Tube	29	44017	2	Truss Head Screw 1/4-20 x 1-1/2" Lg.*
10	44522	1	Leg Tube	30	23917	2	Axle Clamp
11	44033	4	Clamp, Tube	31	43177	4	Lock Washer, 1/4"
12	23882	2	Support Strap	47592		1	Owner's Manual
13	62535	1	Front Angle Assembly				
14	43945	2	Wheel w/Bearings 26"				
19	44016	4	Ball Bearings 3/4" I.D.				

*Purchase Common Hardware Locally.

SpeedPart the fastest way to purchase parts www.speedepart.com

For Agri Fab Discount Parts Call 606-678-9623 or 606-561-4983

SpeedEPart *the fastest way to purchase parts* www.speedepart.com

REPAIR PARTS
Agri-Fab, Inc.
303 West Raymond
Sullivan, IL. 61951
217-728-8388
www.agri-fab.com

© 1999 Agri-Fab, Inc.

www.mymowerparts.com